

Seleccione y copie en memoria con (Ctrl + C) el siguiente código  
**GCYC6TWG8B8Y2DWFV7EVQ8GW93DVFP7XDJB2**

Al finalizar la instalación se requiere y lo pega con (Ctrl + V)

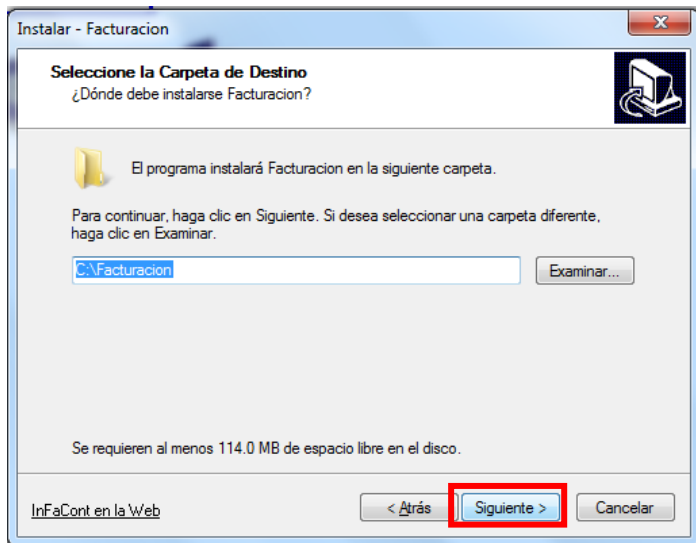

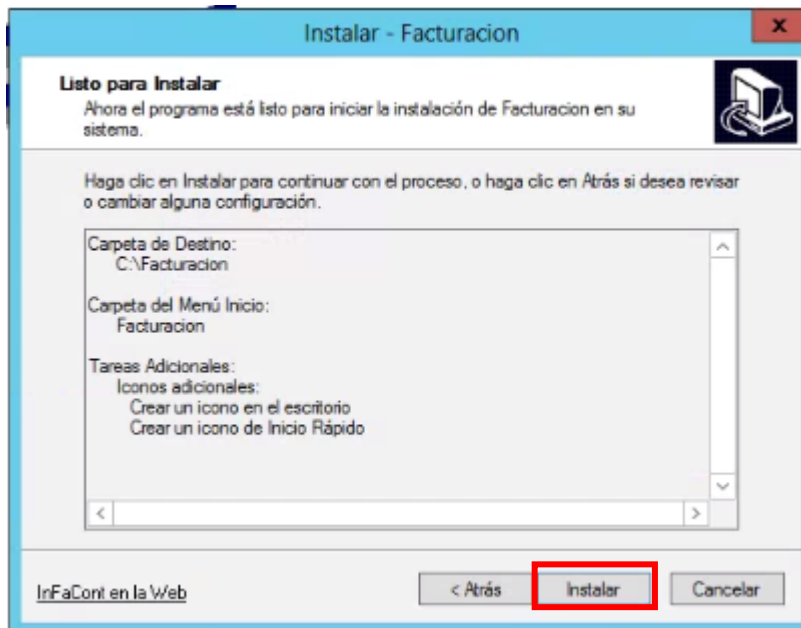

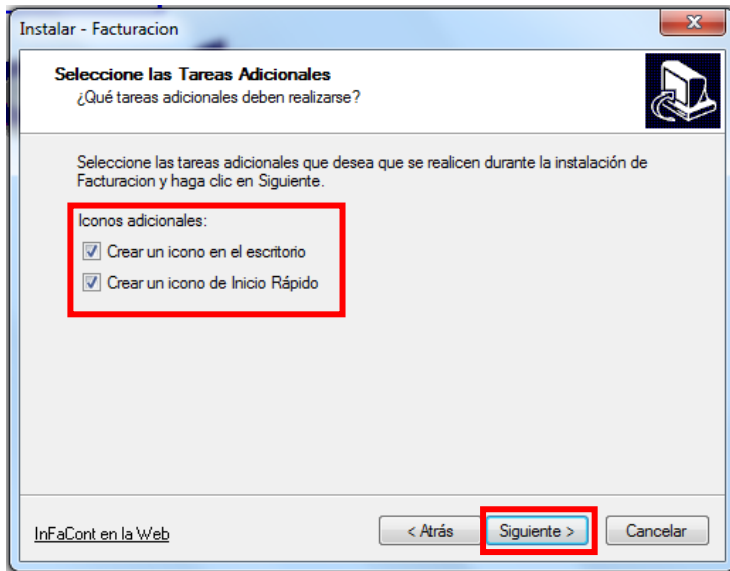
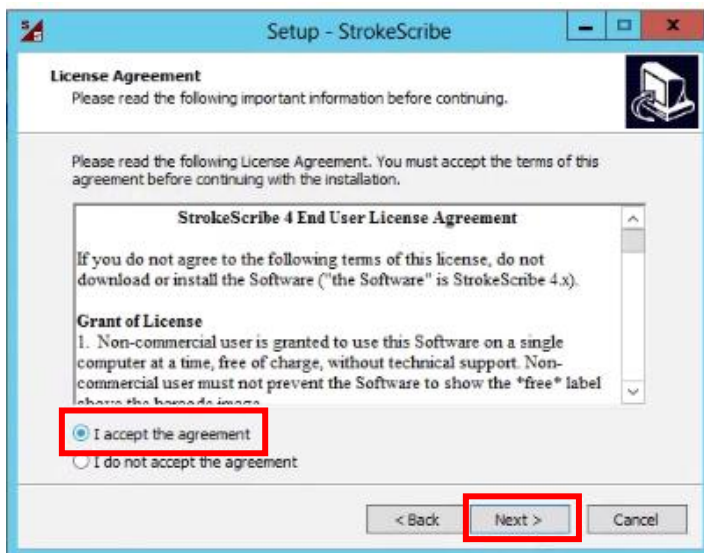
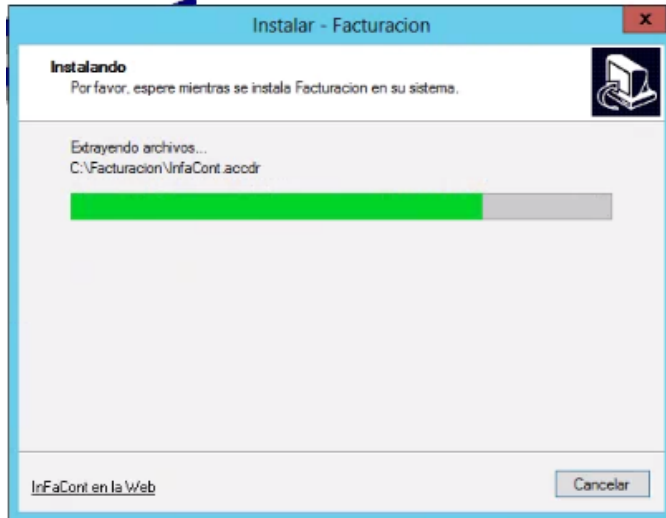

The image shows a Windows-style dialog box titled "Setup - StrokeScribe". The window has a blue title bar with standard minimize, maximize, and close buttons. The main content area is titled "User Information" and contains the instruction "Please enter your information." followed by three text input fields: "User Name:" (containing "Usuario de Windows"), "Organization:" (containing "InFaCont"), and "Serial Number:". The "Serial Number:" field is highlighted with a red rectangular border. At the bottom of the dialog, there are three buttons: "< Back", "Next >", and "Cancel". The "Next >" button is also highlighted with a red rectangular border. A small icon of a computer monitor is visible in the top right corner of the dialog.

Pegue el serial con (Ctrl + V)

[GCYC6TWG8B8Y2DWFV7EVQ8GW93DVFP7XDJB2](#)

Luego clic en Next